

# IGL

Intermodal  
Global  
Logistics

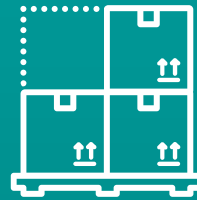

## LOAD CHARTS

---

# DRY 20' CONTAINER CAPACITY

LOADED WITH 100 X 120 CM PALLETS

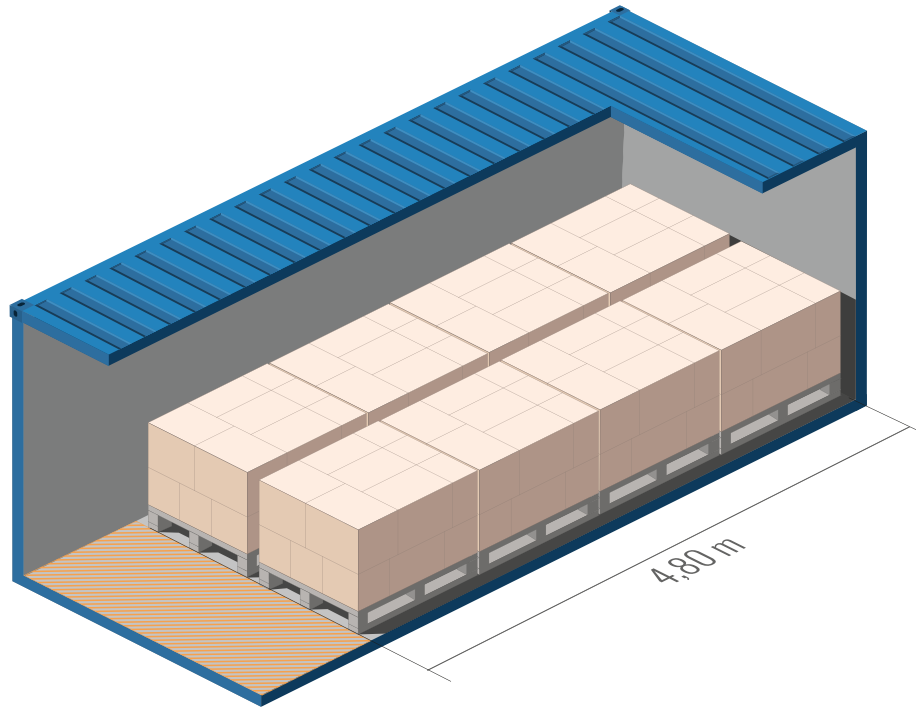

## INTERNAL DIMENSIONS

Width: 2,352 m

Large: 5,898 m

Height: 2,393 m

## EXTERNAL DIMENSIONS

Width: 2,438 m

Large: 6,058 m

Height: 2,591 m

## DOORS

Width: 2,340 m

Large: 2,280 m

## LOAD MÁX.

28,260 Kg

## MGW

30,480 Kg

## TARE

2,220 Kg

## VOLUME

33,20 m<sup>3</sup>

 **LOOSE CARGO SPACE**  
Equivalent to 1 or 1.5 pallet/s

## SCHEME:

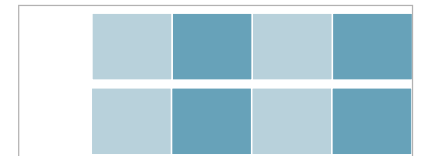

# DRY LOADED WITH 20' CONTAINER

LOADED WITH 10 EURO 80 X 120 CM PALLETS

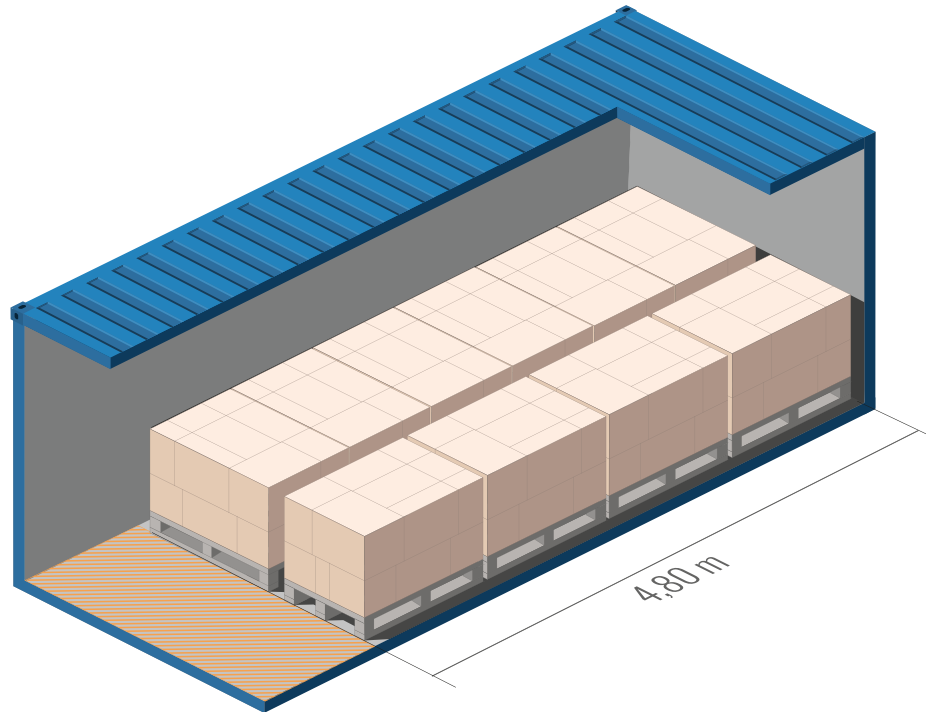

## INTERNAL DIMENSIONS

Width: 2,352 m  
Large: 5,898 m  
Height: 2,393 m

## EXTERNAL DIMENSIONS

Width: 2,438 m  
Large: 6,058 m  
Height: 2,591 m

## DOORS

Width: 2,340 m  
Height: 2,280 m

## LOAD MÁX.

28,260 Kg

## MGW

30,480 Kg

## TARE

2,220 Kg

## VOLUME

33,20 m<sup>3</sup>

 **LOOSE CARGO SPACE**  
Equivalent to 1 pallet

## SCHEME:

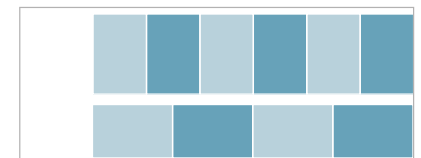

# DRY LOADED WITH 20' CONTAINER

LOADED WITH 10 PALLETS OF 100X120 CM

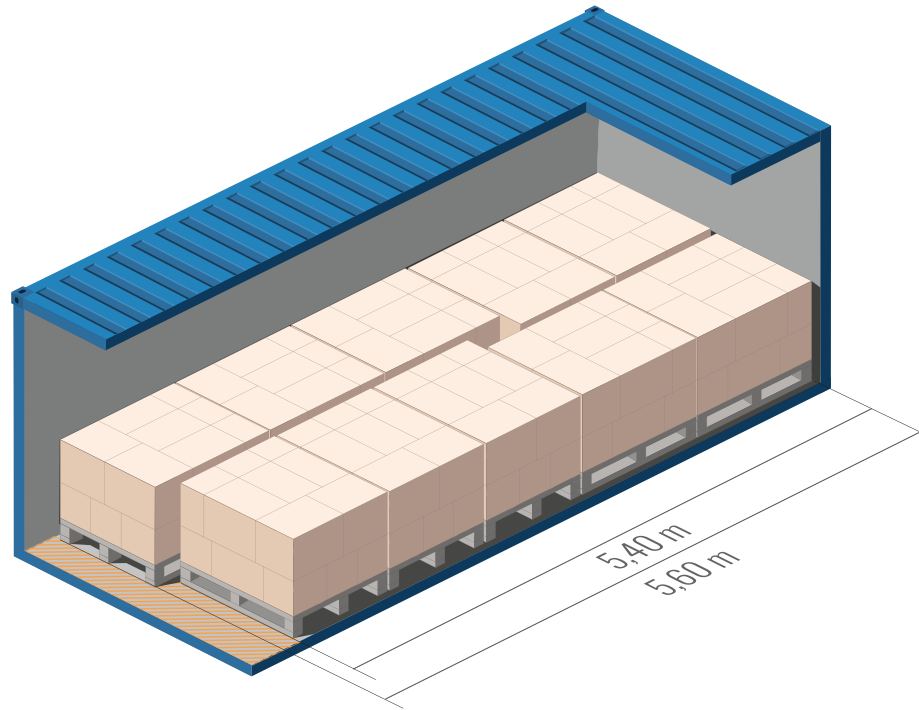

## INTERNAL DIMENSIONS

Width: 2,352 m  
Large: 5,898 m  
Height: 2,393 m

## EXTERNAL DIMENSIONS

Width: 2,438 m  
Large: 6,058 m  
Height: 2,591 m

## DOORS

Width: 2,340 m  
Large: 2,280 m

## LOAD MÁX.

28,260 Kg

## MGW

30,480 Kg

## TARE

2,220 Kg

## VOLUME

33,20 m<sup>3</sup>

 **LOOSE CARGO SPACE**  
Equivalent to 1 pallet

## SCHEME:



# CAPACIDAD CONTENEDOR DRY 20'

LOADED WITH 11 EURO PALLETS OF 80X120 CM



## INTERNAL DIMENSIONS

Width: 2,352 m  
Longitud: 5,898 m  
Height: 2,393 m

## DIMENSIONES EXTERNAS

Width: 2,438 m  
Large: 6,058 m  
Height: 2,591 m

## DOORS

Width: 2,340 m  
Large: 2,280 m

## LOAD MÁX.

28,260 Kg

## MGW

30,480 Kg

## TARE

2,220 Kg

## VOLUME

33,20 m<sup>3</sup>

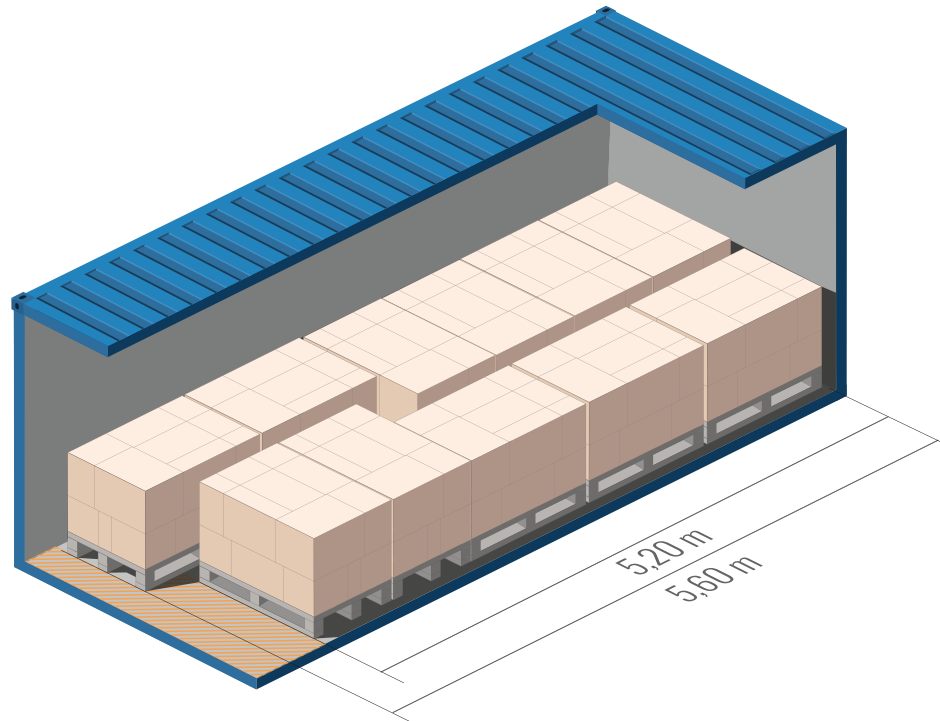

 **LOOSE CARGO SPACE**  
Equivalent to 1 or 1.5 pallet/s

## SCHEME:



# DRY 40' CONTAINER CAPACITY

LOADED WITH 21 PALETS OF 100 X 120 CM

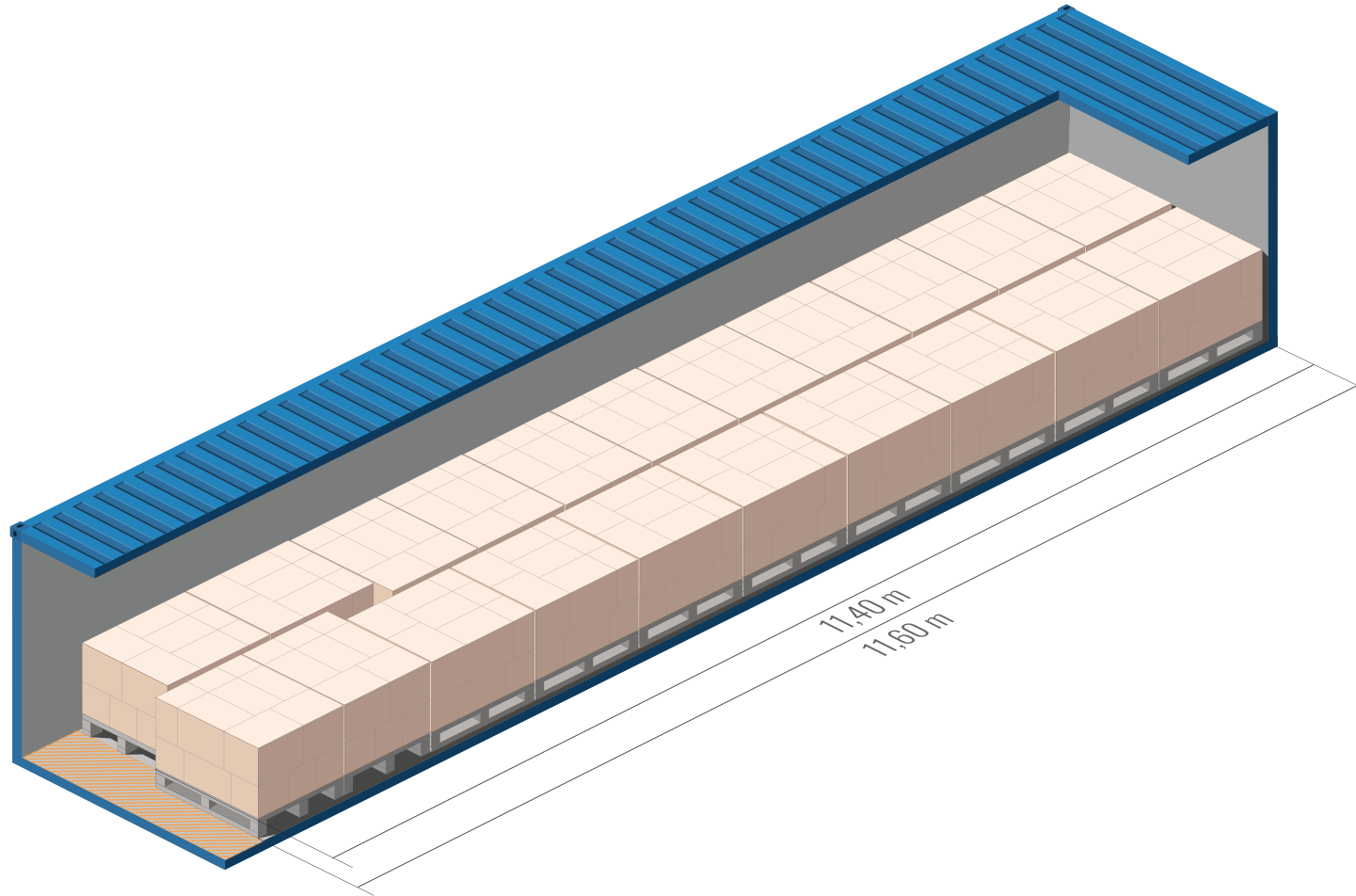

## INTERNAL DIMENSIONS

Width: 2,352 m  
Large: 12,032 m  
Height: 2,393 m

## EXTERNAL DIMENSIONS

Width: 2,438 m  
Large: 12,192 m  
Height: 2,591 m

## DOORS

Width: 2,340 m  
Large: 2,280 m

## LOAD MÁX.

28,650 Kg

## MGW

32,500 Kg

## TARE

3,850 Kg

## VOLUME

67,70 m<sup>3</sup>

 **LOOSE CARGO SPACE**  
Equivalent to 1 pallet

## SCHEME:

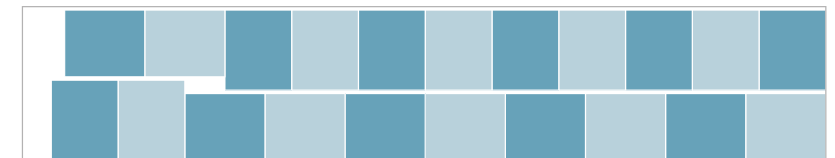

# DRY 40' CONTAINER CAPACITY

LOADED WITH 24 EURO PALLETS OF 80 X 120 CM

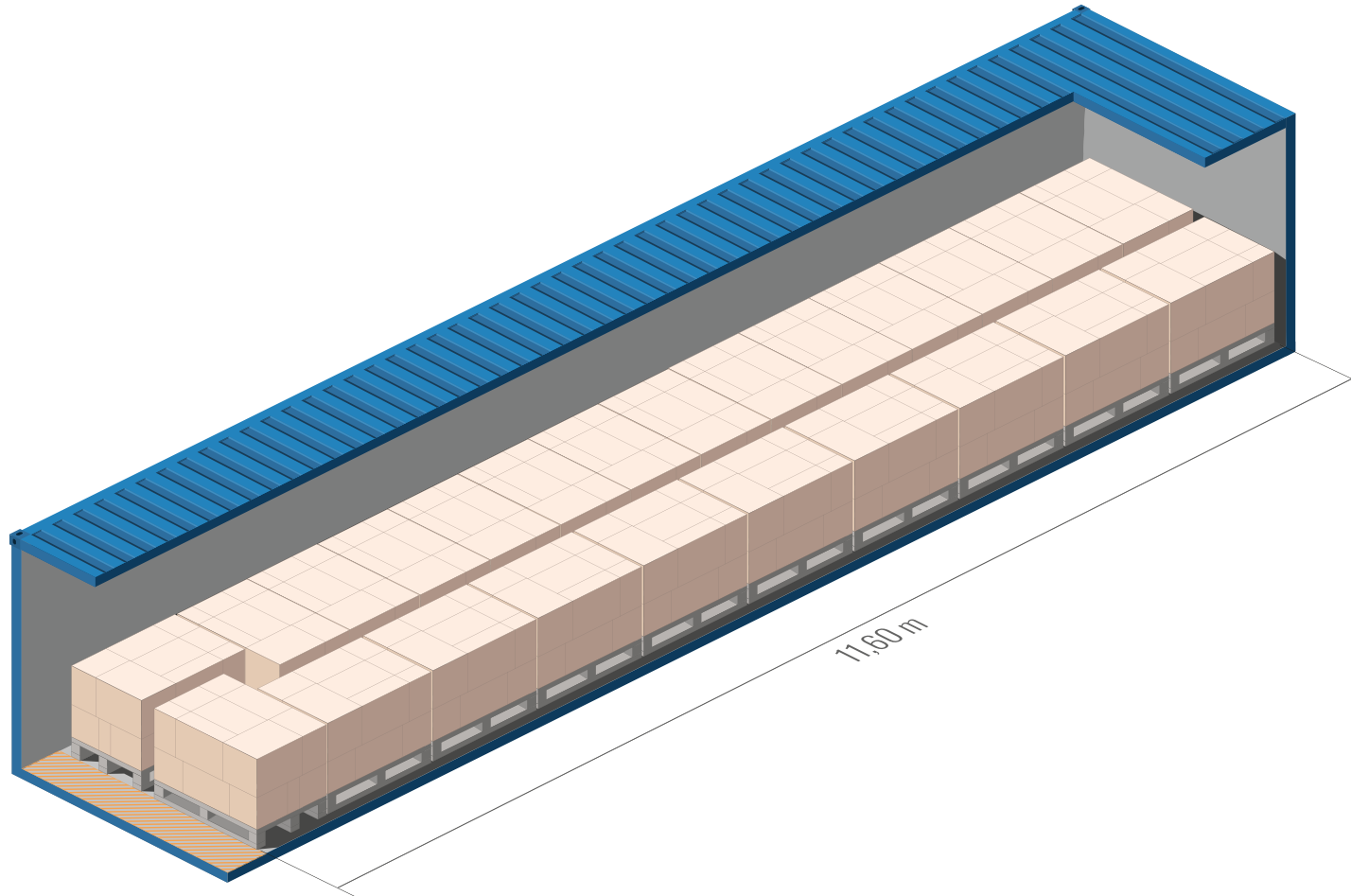

## INTERNAL DIMENSIONS

Width: 2,352 m  
Large: 12,032 m  
Height: 2,393 m

## EXTERNAL DIMENSIONS

Width: 2,438 m  
Large: 12,192 m  
Height: 2,591 m

## DOORS

Width: 2,340 m  
Large: 2,280 m

## LOAD MÁX.

28,650 Kg

## MGW

32,500 Kg

## TARE

3,850 Kg

## VOLUMEV

67,70 m<sup>3</sup>

 **LOOSE CARGO SPACE**  
Equivalent to 1 pallet

## SCHEME:

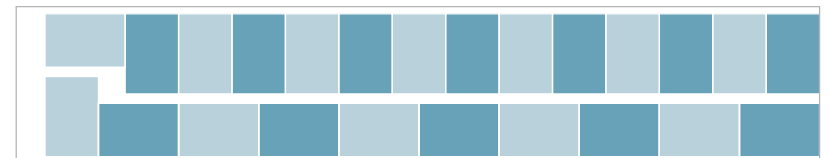

# REEFER 20' CONTAINER CAPACITY

LOADED WITH 10 EURO PALLETS OF 80X120 CM



## INTERNAL DIMENSIONS

Width: 2,294 m

Large: 5,456 m

Height: 2,275 m

## EXTERNAL DIMENSIONS

Width: 2,484 m

Large: 6,058 m

Height: 2,591 m

## DOORS

Width: 2,290 m

Large: 2,291 m

## LOAD MÁX.

27,540 Kg

## MGW

30,480 Kg

## TARE

2,940 Kg

## VOLUME

28,50 m<sup>3</sup>

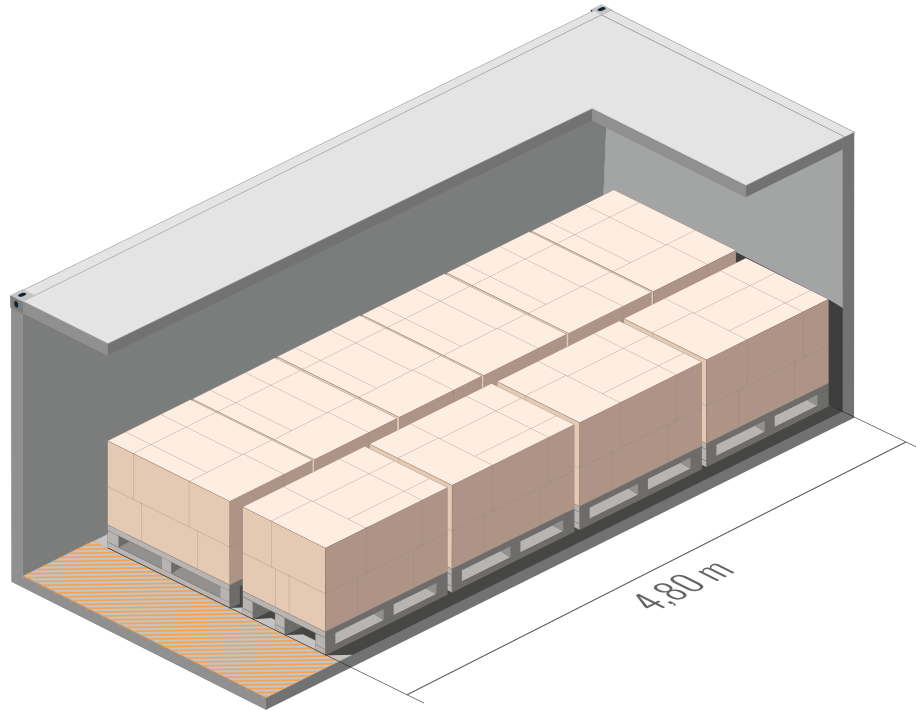

 **LOOSE CARGO SPACE**  
Equivalent to 1 pallet

## SCHEME:





# REEFER 20' HC CONTAINER

## CAPACITY

LOADED WITH 9 PALLETS OF 100X120 CM

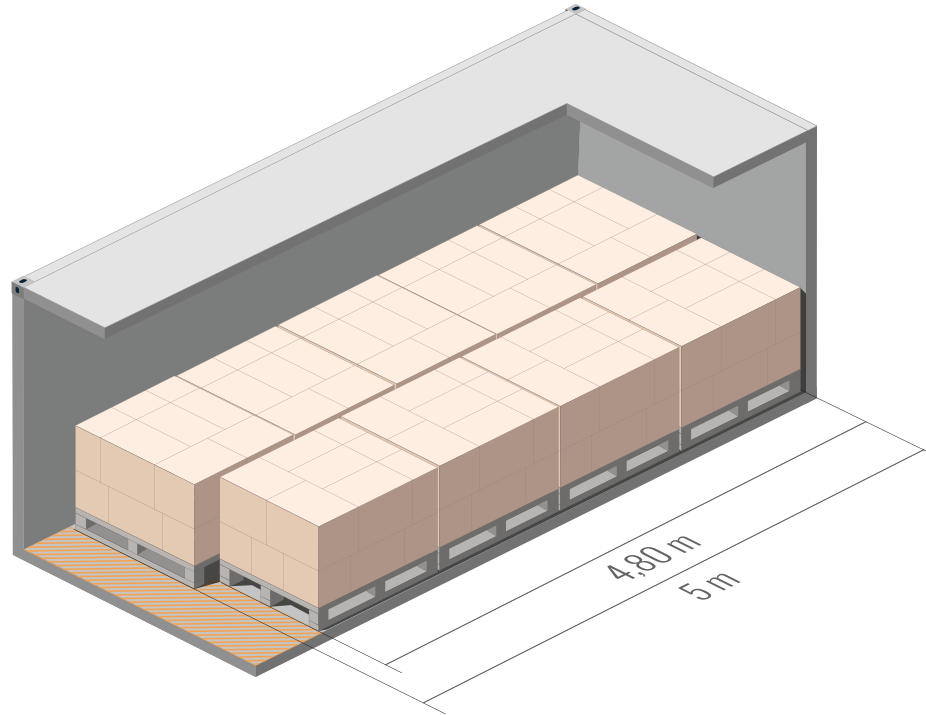

 **LOOSE CARGO SPACE**  
Equivalent to 1 or 1.5 pallet/s



### INTERNAL DIMENSIONS

Width: 2,294 m  
Large: 5,496 m  
Height: 2,275 m

### EXTERNAL DIMENSIONS

Width: 2,484 m  
Large: 6,058 m  
Height: 2,591 m

### DOORS

Width: 2,290 m  
Large: 2,291 m

### LOAD MÁX.

27,540 Kg

### MGW

30,480 Kg

### TARE

2,940 Kg

### VOLUME

28,50 m<sup>3</sup>

### SCHEME:



# REEFER 40' HC CONTAINER

## CAPACITY

LOADED WITH 20 PALLETS OF 100 X 120 CM

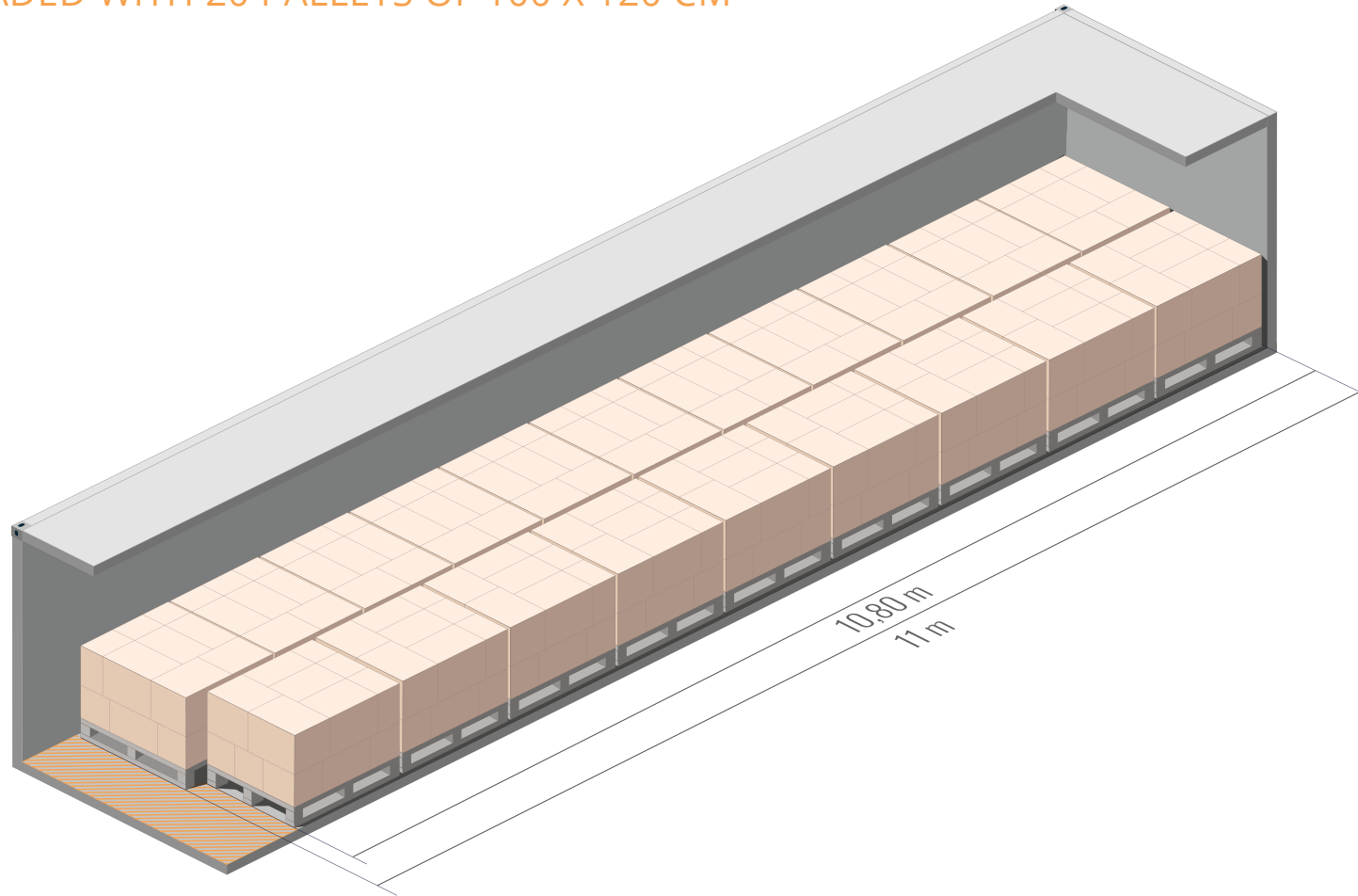

 **LOOSE CARGO SPACE**  
Equivalent to 1 or 1.5 pallet/s



### INTERNAL DIMENSIONS

Width: 2,294 m  
Large: 11,590 m  
Height: 2,557 m

### EXTERNAL DIMENSIONS

Width: 2,438 m  
Large: 12,192 m  
Height: 2,896 m

### DOORS

Width: 2,290 m  
Large: 2,596 m

### LOAD MÁX.

30,420 Kg

### MGW

35,000 Kg

### TARE

4,580 Kg

### VOLUME

67,90 m<sup>3</sup>

### SCHEME:



# REEFER 40' HC CONTAINER CAPACITY

LOADED WITH 20 PALLETS OF 100 X 120 CM  
& 1 EURO PALLET OF 80 X 120 CM

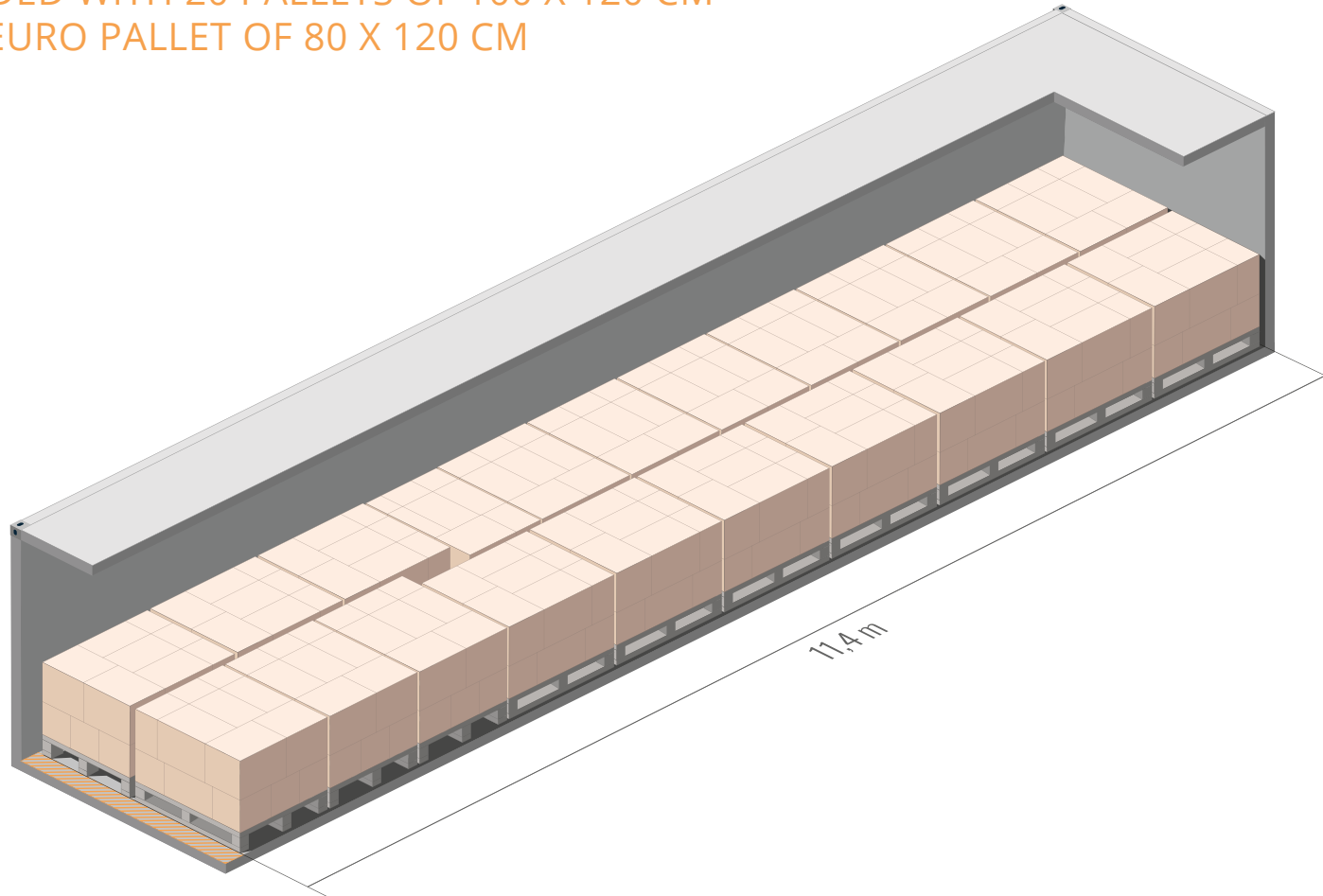

 **LOOSE CARGO SPACE**  
229,4 CM X 19 CM



## INTERNAL DIMENSIONS

Width: 2,294 m  
Large: 11,590 m  
Height: 2,557 m

## EXTERNAL DIMENSIONS

Width: 2,438 m  
Large: 12,192 m  
Height: 2,896 m

## DOORS

Width: 2,290 m  
Large: 2,596 m

## LOAD MÁX.

30,420 Kg

## MGW

35,000 Kg

## TARE

4,580 Kg

## VOLUME

67,90 m<sup>3</sup>

## SCHEME:

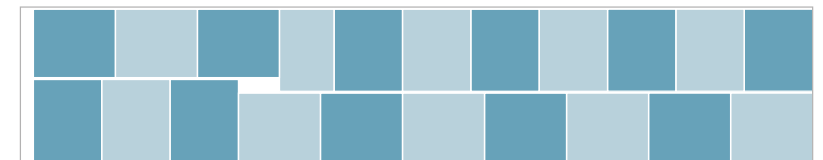

# REEFER 40' HC CONTAINER

## CAPACITY

LOADED WITH 23 EURO PALLETS OF 80X120 CM



### INTERNAL DIMENSIONS

Width: 2,294 m  
Large: 11,590 m  
Height: 2,557 m

### EXTERNAL DIMENSIONS

Width: 2,438 m  
Large: 12,192 m  
Height: 2,896 m

### DOORS

Width: 2,290 m  
Large: 2,596 m

### LOAD MÁX.

30,420 Kg

### MGW

35,000 Kg

### TARE

4,580 Kg

### VOLUME

67,90 m<sup>3</sup>

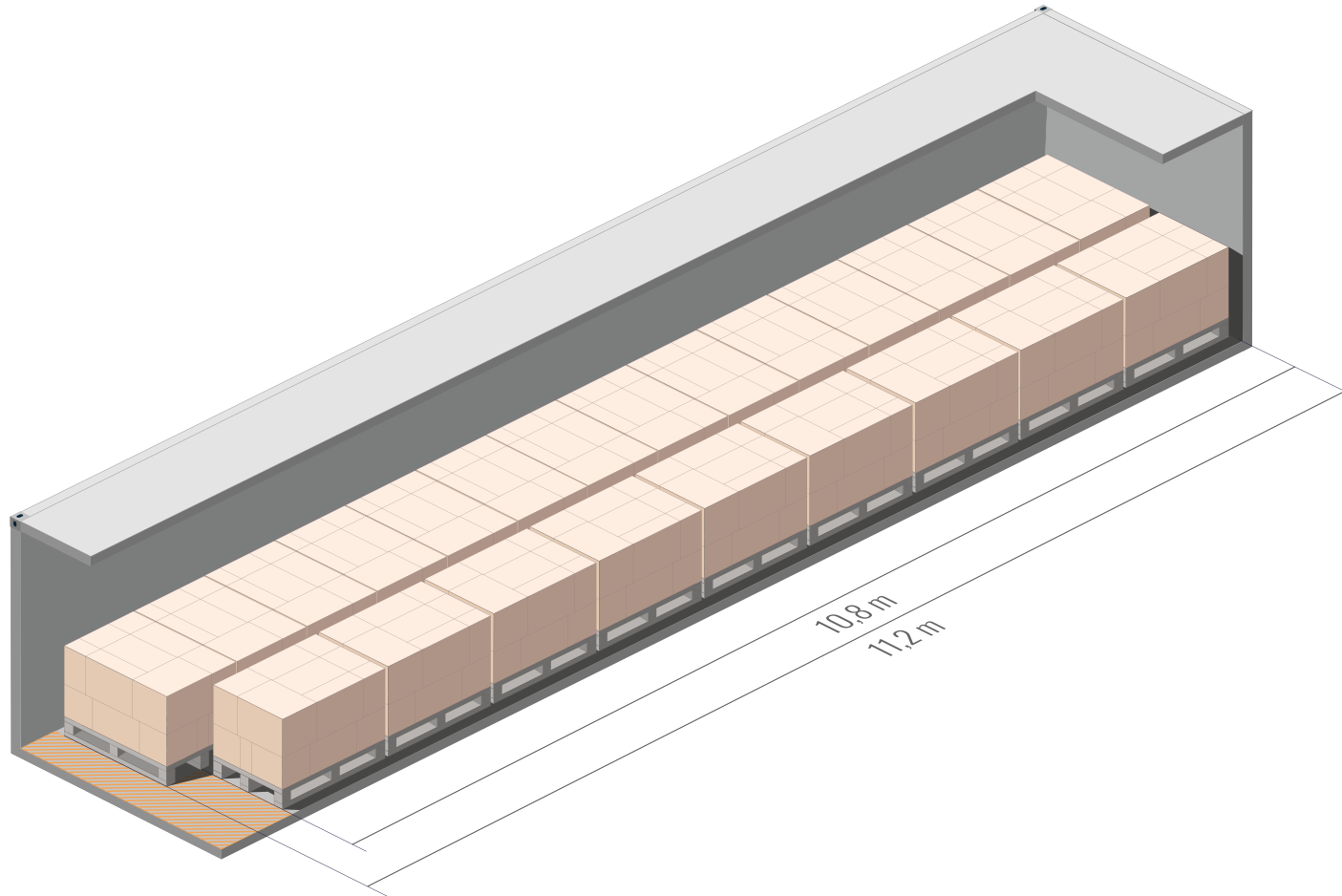

 **LOOSE CARGO SPACE**  
Equivalent to 1 or 1.5 pallet/s

### SCHEME:

